

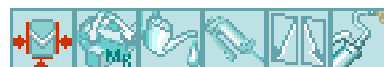

Ball monorail guidance systems KUVE

standard carriage, four-row; corrosion-resistant design possible

The datasheet is only an overview of dimensions and basic load ratings for the selected series. Please ensure that you note all the guidance in these overview pages. Further information is given on many products under the menu item "Description". You can also obtain comprehensive information material via Catalogue selection (www.ina.de/media-service), by e-mail (kataloge@de.ina.com) or telephone +49 (91 32) 82 - 28 97.

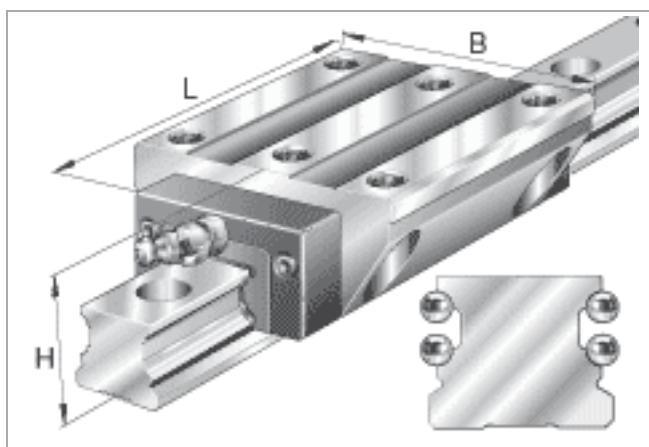

	H mm	B mm	L mm	
KUVE15	⚠	24	47	55,6
KUVE20	⚠	30	63	69,8
KUVE25	⚠	36	70	81,7
KUVE30	⚠	42	90	97,6
KUVE35		48	100	110,4
KUVE45	⚠	60	120	139

Figure 1

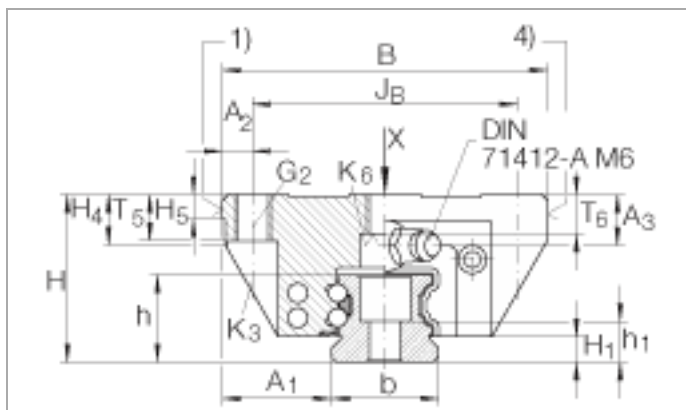

Figure 2

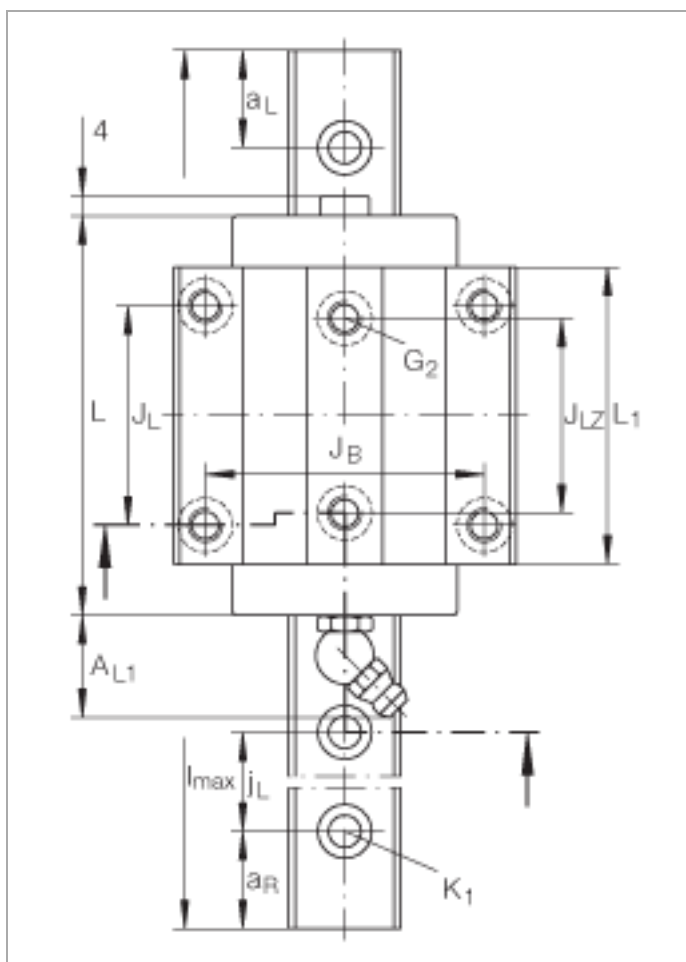
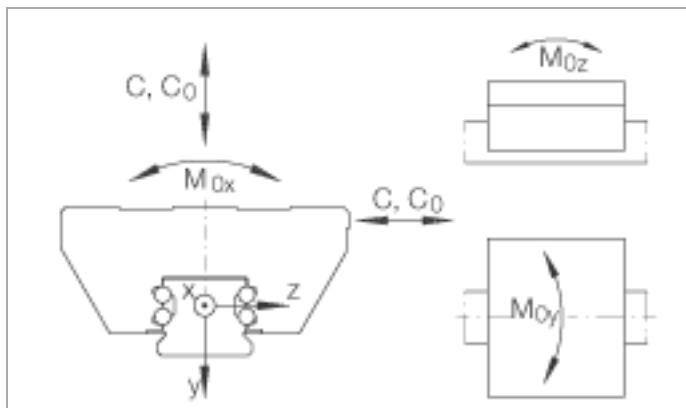

Figure 3





KUVE15

 Note: Product to be withdrawn, not to be used for new designs!

Figure 1, Figure 2, Figure 3,

H	24 mm	
B	47 mm	
L	55,6 mm	
1)		Locating face
4)		Marking
A1	16 mm	
A2	4,5 mm	
A3	4 mm	
AL1	1,5 mm	
aL max	53 mm	a L and a R are dependent on the length l max of the guideway
aL min	20 mm	a L and a R are dependent on the length l max of the guideway
aR max	53 mm	a L and a R are dependent on the length l max of the guideway
aR min	20 mm	a L and a R are dependent on the length l max of the guideway
b	15 mm	Tolerance: -0,005 / -0,03
G2	M5	For screws to ISO 4762-12.9 Max. tightening torque in Nm: M3 = 1,5 M4 = 3 M5 = 5,8 M6 = 10 M8 = 24 M10 = 41 M12 = 83 M14 = 140 M16 = 220 If there is a possibility of settling, the fixing screws should be secured against rotation
h	15,1 mm	
H1	4,3 mm	
h1	8,2 mm	
H4	7,6 mm	
H5	4,5 mm	
JB	38 mm	
JL	30 mm	
jL	60 mm	
JLZ	26 mm	
K1	M4	For screws to DIN 912-12.9 Max. tightening torque: M4 = 5 Nm M5 = 10 Nm M6 = 17 Nm M8 = 41 Nm M12 = 140 Nm If there is a possibility of settling, the fixing screws should be secured against rotation.
K3	M4	For screws to ISO 4762-12.9 Max. tightening torque in Nm: M4 = 5 M5 = 10 M6 = 17 M8 = 41 M10 = 83

		M12 = 140 M14 = 220 If there is a possibility of settling, the fixing screws should be secured against rotation
K6	M4	For screws to DIN 7984-8.8 Max. tightening torque in Nm: M4 = 2,8 M5 = 5,8 M6 = 10 M8 = 24 M10 = 48 M12 = 83 M14 = 130 If there is a possibility of settling, the fixing screws should be secured against rotation
L1	39,8 mm	
l _{max}	1200 mm	Maximum length of single-piece guideways; longer guideways are supplied in several sections and are marked accordingly. Maximum single-piece guideway length of 6 m by agreement.
T5	7,6 mm	
T6	5,8 mm	For location from above: max. screw length for central threaded holes T6 + 2,5 mm
m _w	0,25 kg	Mass of carriage
m _s	1,5 kg/m	Mass of guideway
C	7200 N	Basic load ratings
C ₀	14500 N	Basic load ratings
M _{0x}	150 Nm	Moment rating
M _{0y}	100 Nm	Moment rating
M _{0z}	100 Nm	Moment rating
		Lubrication nipple with tapered head to DIN 71 412 M6, except for KUVE20: DIN 71 412 M5 and KUVE15: Drive fit lubrication nipple

KUVE20

 Note: Product to be withdrawn, not to be used for new designs!

Figure 1, Figure 2, Figure 3,

H	30 mm	
B	63 mm	
L	69,8 mm	
1)		Locating face
4)		Marking
A1	21,5 mm	
A2	5 mm	
A3	8 mm	
AL1	19 mm	
aL max	53 mm	a L and a R are dependent on the length l max of the guideway
aL min	20 mm	a L and a R are dependent on the length l max of the guideway
aR max	53 mm	a L and a R are dependent on the length l max of the guideway
aR min	20 mm	a L and a R are dependent on the length l max of the guideway
b	20 mm	Tolerance: -0,005 / -0,03
G2	M6	For screws to ISO 4762-12.9 Max. tightening torque in Nm: M3 = 1,5 M4 = 3 M5 = 5,8 M6 = 10 M8 = 24 M10 = 41 M12 = 83 M14 = 140 M16 = 220 If there is a possibility of settling, the fixing screws should be secured against rotation
h	17 mm	
H1	4,6 mm	
h1	9,1 mm	
H4	11 mm	
H5	5 mm	
JB	53 mm	
JL	40 mm	
jL	60 mm	
JLZ	35 mm	
K1	M5	For screws to ISO 4762-12.9 Max. tightening torque in Nm: M3 = 2,5 M4 = 5 M5 = 10 M6 = 17 M8 = 41 M12 = 140 M14 = 220 M16 = 340 If there is a possibility of settling, the fixing screws should be secured against rotation
K3	M5	For screws to ISO 4762-12.9 Max. tightening torque in Nm: M4 = 5 M5 = 10

		M6 = 17 M8 = 41 M10 = 83 M12 = 140 M14 = 220 If there is a possibility of settling, the fixing screws should be secured against rotation
K6	M5	For screws to ISO 4762-12.9 Max. tightening torque in Nm: M5 = 10 M6 = 17 M8 = 41 M10 = 83 If there is a possibility of settling, the fixing screws should be secured against rotation
L1	50,4 mm	
l _{max}	1980 mm	Maximum length of single-piece guideways; longer guideways are supplied in several sections and are marked accordingly. Maximum single-piece guideway length of 6 m by agreement.
T5	10 mm	
T6	7,5 mm	For location from above: max. screw length for central threaded holes T6 + 2,5 mm
m _w	0,58 kg	Mass of carriage
m _s	2,2 kg/m	Mass of guideway
C	13100 N	Basic load ratings
C ₀	27000 N	Basic load ratings
M _{0x}	332 Nm	Moment rating
M _{0y}	240 Nm	Moment rating
M _{0z}	240 Nm	Moment rating
		Lubrication nipple with tapered head to DIN 71 412 M6, except for KUVE20: DIN 71 412 M5 and KUVE15: Drive fit lubrication nipple

KUVE25

 Note: Product to be withdrawn, not to be used for new designs!

Figure 1, Figure 2, Figure 3,

H	36 mm	
B	70 mm	
L	81,7 mm	
1)		Locating face
4)		Marking
A1	23,5 mm	
A2	6,5 mm	
A3	11 mm	
AL1	19 mm	
aL max	53 mm	a L and a R are dependent on the length l max of the guideway
aL min	20 mm	a L and a R are dependent on the length l max of the guideway
aR max	53 mm	a L and a R are dependent on the length l max of the guideway
aR min	20 mm	a L and a R are dependent on the length l max of the guideway
b	23 mm	Tolerance: -0,005 / -0,03
G2	M8	For screws to ISO 4762-12.9 Max. tightening torque in Nm: M3 = 1,5 M4 = 3 M5 = 5,8 M6 = 10 M8 = 24 M10 = 41 M12 = 83 M14 = 140 M16 = 220 If there is a possibility of settling, the fixing screws should be secured against rotation
h	18,7 mm	
H1	5,2 mm	
h1	8,7 mm	
H4	10,9 mm	
H5	5 mm	
JB	57 mm	
JL	45 mm	
jL	60 mm	
JLZ	40 mm	
K1	M6	For screws to ISO 4762-12.9 Max. tightening torque in Nm: M3 = 2,5 M4 = 5 M5 = 10 M6 = 17 M8 = 41 M12 = 140 M14 = 220 M16 = 340 If there is a possibility of settling, the fixing screws should be secured against rotation
K3	M6	For screws to ISO 4762-12.9 Max. tightening torque in Nm: M4 = 5 M5 = 10

		<p>M6 = 17 M8 = 41 M10 = 83 M12 = 140 M14 = 220 If there is a possibility of settling, the fixing screws should be secured against rotation</p>
K6	M6	<p>For screws to ISO 4762-12.9 Max. tightening torque in Nm: M5 = 10 M6 = 17 M8 = 41 M10 = 83 If there is a possibility of settling, the fixing screws should be secured against rotation</p>
L1	60,7 mm	
l _{max}	1980 mm	<p>Maximum length of single-piece guideways; longer guideways are supplied in several sections and are marked accordingly. Maximum single-piece guideway length of 6 m by agreement.</p>
T5	10 mm	
T6	10 mm	<p>For location from above: max. screw length for central threaded holes T6 + 2,5 mm</p>
m _w	0,71 kg	Mass of carriage
m _s	2,7 kg/m	Mass of guideway
C	17900 N	Basic load ratings
C ₀	37000 N	Basic load ratings
M _{0x}	510 Nm	Moment rating
M _{0y}	395 Nm	Moment rating
M _{0z}	395 Nm	Moment rating
		<p>Lubrication nipple with tapered head to DIN 71 412 M6, except for KUVE20: DIN 71 412 M5 and KUVE15: Drive fit lubrication nipple</p>

KUVE30

 Note: Product to be withdrawn, not to be used for new designs!

Figure 1, Figure 2, Figure 3,

H	42 mm	
B	90 mm	
L	97,6 mm	
1)		Locating face
4)		Marking
A1	31 mm	
A2	9 mm	
A3	11,25 mm	
AL1	19 mm	
aL max	71 mm	a L and a R are dependent on the length l max of the guideway
aL min	20 mm	a L and a R are dependent on the length l max of the guideway
aR max	71 mm	a L and a R are dependent on the length l max of the guideway
aR min	20 mm	a L and a R are dependent on the length l max of the guideway
b	28 mm	Tolerance: -0,005 / -0,03
G2	M10	For screws to ISO 4762-12.9 Max. tightening torque in Nm: M3 = 1,5 M4 = 3 M5 = 5,8 M6 = 10 M8 = 24 M10 = 41 M12 = 83 M14 = 140 M16 = 220 If there is a possibility of settling, the fixing screws should be secured against rotation
h	23,5 mm	
H1	6 mm	
h1	11,5 mm	
H4	13,8 mm	
H5	6 mm	
JB	72 mm	
JL	52 mm	
jL	80 mm	
JLZ	44 mm	
K1	M8	For screws to ISO 4762-12.9 Max. tightening torque in Nm: M3 = 2,5 M4 = 5 M5 = 10 M6 = 17 M8 = 41 M12 = 140 M14 = 220 M16 = 340 If there is a possibility of settling, the fixing screws should be secured against rotation
K3	M8	For screws to ISO 4762-12.9 Max. tightening torque in Nm: M4 = 5 M5 = 10

		M6 = 17 M8 = 41 M10 = 83 M12 = 140 M14 = 220 If there is a possibility of settling, the fixing screws should be secured against rotation
K6	M8	For screws to DIN 7984-8.8 Max. tightening torque in Nm: M4 = 2,8 M5 = 5,8 M6 = 10 M8 = 24 M10 = 48 M12 = 83 M14 = 130 If there is a possibility of settling, the fixing screws should be secured against rotation
L1	72 mm	
l _{max}	2000 mm	Maximum length of single-piece guideways; longer guideways are supplied in several sections and are marked accordingly. Maximum single-piece guideway length of 6 m by agreement.
T5	12 mm	
T6	12 mm	For location from above: max. screw length for central threaded holes T6 + 2,5 mm
m _w	1,4 kg	Mass of carriage
m _s	4,3 kg/m	Mass of guideway
C	27500 N	Basic load ratings
C ₀	55000 N	Basic load ratings
M _{0x}	970 Nm	Moment rating
M _{0y}	700 Nm	Moment rating
M _{0z}	700 Nm	Moment rating
		Lubrication nipple with tapered head to DIN 71 412 M6, except for KUV20: DIN 71 412 M5 and KUV15: Drive fit lubrication nipple

KUVE35

Figure 1, Figure 2, Figure 3,

H	48 mm	
B	100 mm	
L	110,4 mm	
1)		Locating face
4)		Marking
A1	33 mm	
A2	9 mm	
A3	12,3 mm	
AL1	19 mm	
aL max	71 mm	a L and a R are dependent on the length l max of the guideway
aL min	20 mm	a L and a R are dependent on the length l max of the guideway
aR max	71 mm	a L and a R are dependent on the length l max of the guideway
aR min	20 mm	a L and a R are dependent on the length l max of the guideway
b	34 mm	Tolerance: -0,005 / -0,03
G2	M10	For screws to ISO 4762-12.9 Max. tightening torque in Nm: M3 = 1,5 M4 = 3 M5 = 5,8 M6 = 10 M8 = 24 M10 = 41 M12 = 83 M14 = 140 M16 = 220 If there is a possibility of settling, the fixing screws should be secured against rotation
h	27 mm	
H1	6,8 mm	
h1	15 mm	
H4	14,3 mm	
H5	6,5 mm	
JB	82 mm	
JL	62 mm	
jL	80 mm	
JLZ	52 mm	
K1	M8	For screws to ISO 4762-12.9 Max. tightening torque in Nm: M3 = 2,5 M4 = 5 M5 = 10 M6 = 17 M8 = 41 M12 = 140 M14 = 220 M16 = 340 If there is a possibility of settling, the fixing screws should be secured against rotation
K3	M8	For screws to ISO 4762-12.9 Max. tightening torque in Nm: M4 = 5 M5 = 10 M6 = 17 M8 = 41 M10 = 83

		M12 = 140 M14 = 220 If there is a possibility of settling, the fixing screws should be secured against rotation
K6	M8	For screws to ISO 4762-12.9 Max. tightening torque in Nm: M5 = 10 M6 = 17 M8 = 41 M10 = 83 If there is a possibility of settling, the fixing screws should be secured against rotation
L1	80 mm	
l _{max}	2960 mm	Maximum length of single-piece guideways; longer guideways are supplied in several sections and are marked accordingly. Maximum single-piece guideway length of 6 m by agreement.
T5	13 mm	
T6	12 mm	For location from above: max. screw length for central threaded holes T6 + 2,5 mm
mw	2,02 kg	Mass of carriage
ms	5,7 kg/m	Mass of guideway
C	38000 N	Basic load ratings
C ₀	72000 N	Basic load ratings
M _{0x}	1465 Nm	Moment rating
M _{0y}	1020 Nm	Moment rating
M _{0z}	1020 Nm	Moment rating
		Lubrication nipple with tapered head to DIN 71 412 M6, except for KUV20: DIN 71 412 M5 and KUV15: Drive fit lubrication nipple

KUVE45

 Note: Product to be withdrawn, not to be used for new designs!

Figure 1, Figure 2, Figure 3,

H	60 mm	
B	120 mm	
L	139 mm	
1)		Locating face
4)		Marking
A1	37,5 mm	
A2	10 mm	
A3	16,5 mm	
AL1	19 mm	
aL max	94 mm	a L and a R are dependent on the length l max of the guideway
aL min	20 mm	a L and a R are dependent on the length l max of the guideway
aR max	94 mm	a L and a R are dependent on the length l max of the guideway
aR min	20 mm	a L and a R are dependent on the length l max of the guideway
b	45 mm	Tolerance: -0,005 / -0,03
G2	M12	For screws to ISO 4762-12.9 Max. tightening torque in Nm: M3 = 1,5 M4 = 3 M5 = 5,8 M6 = 10 M8 = 24 M10 = 41 M12 = 83 M14 = 140 M16 = 220 If there is a possibility of settling, the fixing screws should be secured against rotation
h	34,2 mm	
H1	9,8 mm	
h1	16,2 mm	
H4	19,8 mm	
H5	9 mm	
JB	100 mm	
JL	80 mm	
jL	105 mm	
JLZ	60 mm	
K1	M12	For screws to ISO 4762-12.9 Max. tightening torque in Nm: M3 = 2,5 M4 = 5 M5 = 10 M6 = 17 M8 = 41 M12 = 140 M14 = 220 M16 = 340 If there is a possibility of settling, the fixing screws should be secured against rotation
K3	M10	For screws to ISO 4762-12.9 Max. tightening torque in Nm: M4 = 5 M5 = 10

		<p>M6 = 17 M8 = 41 M10 = 83 M12 = 140 M14 = 220 If there is a possibility of settling, the fixing screws should be secured against rotation</p>
K6	M10	<p>For screws to ISO 4762-12.9 Max. tightening torque in Nm: M5 = 10 M6 = 17 M8 = 41 M10 = 83 If there is a possibility of settling, the fixing screws should be secured against rotation</p>
L1	102,5 mm	
l _{max}	2940 mm	<p>Maximum length of single-piece guideways; longer guideways are supplied in several sections and are marked accordingly. Maximum single-piece guideway length of 6 m by agreement.</p>
T5	15 mm	
T6	15 mm	<p>For location from above: max. screw length for central threaded holes T6 + 2,5 mm</p>
m _w	3,75 kg	Mass of carriage
m _s	9,2 kg/m	Mass of guideway
C	69000 N	Basic load ratings
C ₀	141000 N	Basic load ratings
M _{0x}	3610 Nm	Moment rating
M _{0y}	2485 Nm	Moment rating
M _{0z}	2485 Nm	Moment rating
		<p>Lubrication nipple with tapered head to DIN 71 412 M6, except for KUVE20: DIN 71 412 M5 and KUVE15: Drive fit lubrication nipple</p>